

## Mantis<sup>®</sup> Deluxe XP Tiller Assembly

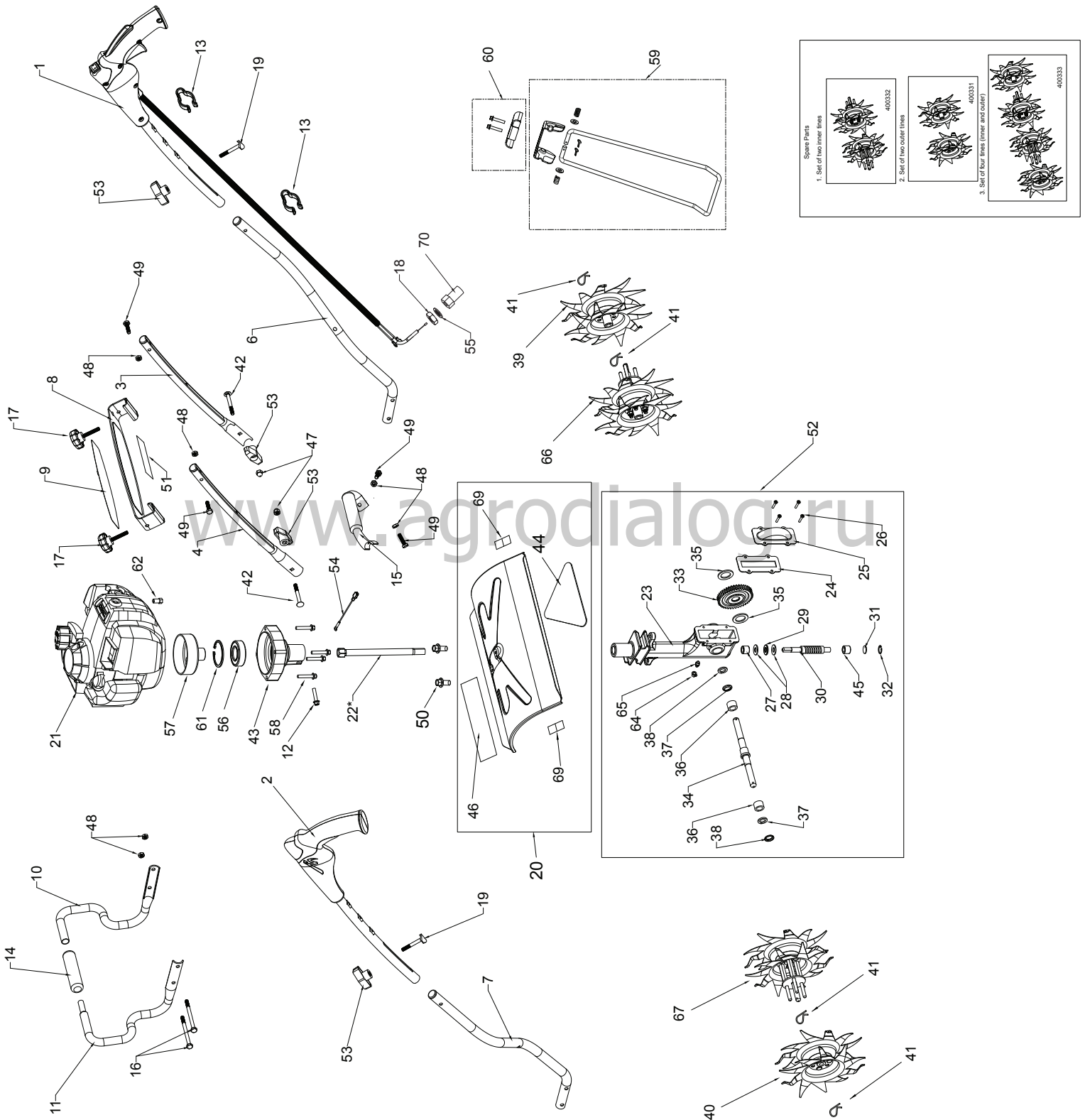

Key	Qty.	Part No.	Description	Key	Qty.	Part No.	Description
1	1	430004	Trigger Handle Assembly, 4 Cycle Engine, Right	35	2	430	Worm Gear Thrust Washer
2	1	430006	Handle Assembly, Left	36	2	432	Worm Gear Bearing
3	1	430053	Middle Handle W/Plug, Right	37	2	434	Bearing
4	1	430052	Middle Handle W/Plug, Left	38	2	435	Bearing Seal Retainer
6	1	430051	Lower Handle W/Plug, Right	39	1	400328	Tine Assembly, Outer Right
7	1	430050	Lower Handle W/Plug, Left	40	1	400327	Tine Assembly, Outer Left
8	1	430021	Handle Brace	41	2	418-1	Tine Retaining Pin
9	1	400638	Label, Handle Brace	42	2	430039	Carriage Bolt 1/4-20 X 2.25"
10	1	430023	Loop Handle Right Half	43	1	400307	Engine Flange
11	1	430022	Loop Handle Left Half	44	1	400631	Triangle Warning Label (4 Cycle Engine)
12	1	910502	10-32 X 3/4" Flange Bolt	45	1	458	Roller Bearing
13	2	478	Throttle Clip	46	1	430058	Mantis Logo Label
14	2	430025	Foam Grip	47	2	395	Acorn Nut
15	1	430049	Carry Handle W/Grip	48	6	972	1/4-20 Two-Way Lock Nut
16	2	4049	Bolt 1/4-20 X 3.25"	49	4	144-2	1/4-20 X 1.125 Hex Head Cap Screw
17	2	430038	Knob, 1/4-20 X 1.5 Male	50	2	M9452	Bolt 1/4-20x1/2" Long
18	1	4078	M6 Jam Nut	51	1	430057	Warning Label
19	2	430048	Curved Head Bolt, 1/4-20 X2"	52	1	400302	Transmission Assembly*
20	1	430209	Fender Guard with Labels	53	4	400523	Knob, Two Prongs, Female
21	1	400916	Engine Assembly-35cc Honda®	54	1	430043	Ground Wire Jumper, 4 Cycle Engine
22	1	468	Drive Shaft	55	1	4079	M6 Internal Lock Washer
23	1	400301	Worm Gear Housing	56	1	400132	Bearing
24	1	436	Gasket	57	1	400308	Clutch Drum
25	1	437A	Gear Housing Cover	58	4	400529	M6x33mm Flange Bolt
26	4	651	#8 Self Tapping Screw	59	1	410158	Kickstand, Stand Assembly
27	1	423	Roller Bearing	60	1	430037	Kickstand, Bracket And Hardware
28	2	425	Worm Bearing Race	61	1	400524	Retaining Ring
29	1	424	Worm Thrust Bearing	62	1	400310	Throttle Stop, Honda® 34cc
30	1	422	Worm Shaft	64	1	400313	Dust Cap for Grease Fitting
31	1	426	Worm Disk	65	1	400300	Grease Fitting
32	1	428	Retaining Ring	66	1	400330	Tine Assembly, Inner Right
33	1	429	Worm Gear	67	1	400329	Tine Assembly, Inner Left
34	1	431	Tine Shaft	69	2	400635	Label XP Tine Warning
				70	1	400310	Throttle Stop

\* Includes Key #22